

Licensing Act 2003

Premises Licence



Premises Licence Number: 2023/02069/LAPR

Part 1 – Premises details

Postal address of premises, or if none, OS map reference or description of the premises

Ground & First Floor
Broadway Bar & Grill
474 - 476 Fulham Road

Post town: London

Post code: SW6 1BY

Telephone:

Where the licence is time limited the dates:

Not Applicable

Licensable activities authorised by the licence:

Exhibition of a Film -Indoors Only
Performance of Live Music -Indoors Only
Playing of Recorded Music -Indoors Only
Entertainment Similar to Music or Dance -Indoors Only
Provision of Late Night Refreshment -Indoors Only
Sale of Alcohol On and Off the Premises

The licence authorises the carrying out of the following licensable activities on the days and at the times specified below:

Exhibition of a Film -Indoors Only
Monday to Sunday 10:00 - 01:00

Performance of Live Music -Indoors Only
Monday to Sunday 10:00 - 01:00

Playing of Recorded Music -Indoors Only
Monday to Sunday 10:00 - 01:00

Entertainment Similar to Music or Dance -Indoors Only
Monday to Sunday 10:00 - 01:00

Provision of Late Night Refreshment -Indoors Only

Monday to Sunday 23:00 - 02:00 (First Floor)

Monday to Sunday 23:00 - 01:00 (Ground Floor)

Sale of Alcohol On and Off the Premises

Monday to Sunday 10:00 - 01:00 (Ground Floor)

Monday to Sunday 10:00 - 02:00 (First Floor)

Non Standard Timings and Seasonal Variations: On Saturdays when Chelsea Football Club play at home the start time will be 11:00

The opening hours of the premises:

Monday to Sunday 10:00 - 02:30

Where the licence authorises supplies of alcohol whether these are on and / or off supplies:

On and off the premises

Part 2

Name, (registered) address, telephone number and email (where relevant) of holder of premises licence:

Eduardo Dantas

[REDACTED]

[REDACTED]

[REDACTED]

Email: [REDACTED]

Registered number of holder, for example company number, charity number (where applicable):

Not applicable

Name, address and telephone number of designated premises supervisor where the premises licence authorises the supply of alcohol:

Eduardo Dantas

[REDACTED]

[REDACTED]

[REDACTED]

[REDACTED]

Licensing Authority: London Borough Of Lambeth

Personal Licence Number: 02600

Annex 1 – Mandatory Conditions

1. Mandatory Condition

(1) The responsible person must ensure that staff on relevant premises do not carry out, arrange or participate in any irresponsible promotions in relation to the premises.

(2) In this paragraph, an irresponsible promotion means any one or more of the following activities, or substantially similar activities, carried on for the purpose of encouraging the sale or supply of alcohol for consumption on the premises—

(a) games or other activities which require or encourage, or are designed to require or encourage, individuals to—

(i) drink a quantity of alcohol within a time limit (other than to drink alcohol sold or supplied on the premises before the cessation of the period in which the responsible person is authorised to sell or supply alcohol), or

(ii) drink as much alcohol as possible (whether within a time limit or otherwise);

(b) provision of unlimited or unspecified quantities of alcohol free or for a fixed or discounted fee to the public or to a group defined by a particular characteristic in a manner which carries a significant risk of undermining a licensing objective;

(c) provision of free or discounted alcohol or any other thing as a prize to encourage or reward the purchase and consumption of alcohol over a period of 24 hours or less in a manner which carries a significant risk of undermining a licensing objective;

(d) selling or supplying alcohol in association with promotional posters or flyers on, or in the vicinity of, the premises which can reasonably be considered to condone, encourage or glamorise anti-social behaviour or to refer to the effects of drunkenness in any favourable manner;

(e) dispensing alcohol directly by one person into the mouth of another (other than where that other person is unable to drink without assistance by reason of disability).

2. Mandatory Condition

The responsible person shall ensure that free potable water is provided on request to customers where it is reasonably available.

3. Mandatory Condition

1) The premises licence holder or club premises certificate holder must ensure that an age verification policy is adopted in respect of the premises in relation to the sale or supply of alcohol.

(2) The designated premises supervisor in relation to the premises licence must ensure that the supply of alcohol at the premises is carried on in accordance with the age verification policy.

(3) The policy must require individuals who appear to the responsible person to be under 18 years of age (or such older age as may be specified in the policy) to produce on request, before being served alcohol, identification bearing their photograph, date of birth and either—

- (a) a holographic mark, or
- (b) an ultraviolet feature.

4. Mandatory Condition

The responsible person must ensure that—

(a) where any of the following alcoholic drinks is sold or supplied for consumption on the premises (other than alcoholic drinks sold or supplied having been made up in advance ready for sale or supply in a securely closed container) it is available to customers in the following measures—

- (i) beer or cider: ½ pint;
- (ii) gin, rum, vodka or whisky: 25 ml or 35 ml; and
- (iii) still wine in a glass: 125 ml;

(b) these measures are displayed in a menu, price list or other printed material which is available to customers on the premises; and

(c) where a customer does not in relation to a sale of alcohol specify the quantity of alcohol to be sold, the customer is made aware that these measures are available.

5. Mandatory Condition

1. A relevant person shall ensure that no alcohol is sold or supplied for consumption on or off the premises for a price which is less than the permitted price.

2. For the purposes of the condition set out in paragraph 1—

(a) "duty" is to be construed in accordance with the Alcoholic Liquor Duties Act 1979;

(b) "permitted price" is the price found by applying the formula—

$$P = D + (D \times V)$$

where—

- (i) P is the permitted price,
- (ii) D is the amount of duty chargeable in relation to the alcohol as if the duty were charged on the date of the sale or supply of the alcohol, and
- (iii) V is the rate of value added tax chargeable in relation to the alcohol as if the value added tax were charged on the date of the sale or supply of the alcohol;

(c) "relevant person" means, in relation to premises in respect of which there is in force a premises licence—

- (i) the holder of the premises licence,
- (ii) the designated premises supervisor (if any) in respect of such a licence, or
- (iii) the personal licence holder who makes or authorises a supply of alcohol under such a licence;

(d) "relevant person" means, in relation to premises in respect of which there is in force a club premises certificate, any member or officer of the club present on the premises in a capacity which enables the member or officer to prevent the supply in question; and

(e) "value added tax" means value added tax charged in accordance with the Value Added Tax Act 1994.

3. Where the permitted price given by Paragraph (b) of paragraph 2 would (apart from this paragraph) not be a whole number of pennies, the price given by that sub-paragraph shall be taken to be the price actually given by that sub-paragraph rounded up to the nearest penny.

4.(1) Sub-paragraph (2) applies where the permitted price given by Paragraph (b) of paragraph 2 on a day ("the first day") would be different from the permitted price on the next day ("the second day") as a result of a change to the rate of duty or value added tax.

(2) The permitted price which would apply on the first day applies to sales or supplies of alcohol which take place before the expiry of the period of 14 days beginning on the second day.

6. Mandatory Condition

(1) No supply of alcohol may be made under the premises licence-

(a) at a time when there is no designated premises supervisor in respect of the premises licence, or

(b) at a time when the designated premises supervisor does not hold a personal licence or his personal licence is suspended.

(2) Every supply of alcohol under the premises licence must be made or authorised by a person who holds a personal licence.

7. Mandatory Condition

Admission of children must be restricted in accordance with any recommendation made by the film classification body specified in the licence, or, where the licensing authority has notified the holder of the licence that it considers a classification is necessary then, admission of children must be restricted in accordance with any recommendation made by that licensing authority.

In this section -

"children" means persons under the age of 18; and

"film classification body" means the person or persons designated as the authority under section 4 of the Video Recordings Act 1984 (c.39) (authority to determine suitability of video works for classification).

8. Mandatory Condition

Where this licence includes a condition that at specified times one or more individuals must be at the premises to carry out a security activity, each individual must be licensed by the Security Industry Authority, with the following exceptions:

a) premises where the premises licence authorises plays or films

b) any occasion mentioned in paragraph 8(3)(b) or (c) of Schedule 2 to the Private Security Industry Act 2001 (premises being used exclusively by a club with a club premises certificate, under a temporary event notice authorising plays or films or under a gaming licence), or

c) any occasion within paragraph 8(3)(d) of Schedule 2 to the Private Security Industry Act 2001.

Annex 2 – Conditions consistent with the operating Schedule

9. There shall be no irresponsible drinks promotions (e.g. all you can drink for £10).
10. The operators shall support the Pubwatch scheme for so long as the police require and the scheme is adequately supported by other operators.
11. On the ground floor of the premises, on match days/victory parades at Chelsea FC plastic glasses shall be used for a period 2 hours before the advertised kick off time and until 1 hour after the match/event, unless police give 7 days notice when the period shall be three hours before and three hours after.
12. The operators shall maintain the installations for the safety of those using the premises, including electrical installations, in accordance with the manufacturers' recommendations. Where appropriate, Certificates from a recognised body member will be obtained and copies will be produced within a reasonable time following demand to a Local Authority officer
13. Any special effects or mechanical installations that have not previously been authorised by the council shall be arranged and stored so as to minimise any risk to the safety of those using the premises. The following special effects will only be used on 7 days prior notice being given to the council.

Dry ice and cryogenic fog
Smoke machines and fog generators
Pyrotechnics including fireworks
Firearms
Motor vehicles
Lasers
Explosives and highly flammable substances.
14. When a microphone is available, an announcement shall be made at the end of the evening reminding customers that the premises are in a residential area and asking them to leave quietly.
15. No arrangements shall be made for any deliveries to or collections from the premises between 11pm and 6am daily.
16. The operator shall ensure that all litter and waste outside the premises is removed and disposed of with other waste from the premises.
17. The licensee shall take all reasonable steps to ensure that there is no unauthorised advertising of events to be held at the premises.
18. Staff and door staff shall be instructed to comply with the company's policy on controlling (amongst other things) queues and dispersal.
19. Under 16's shall not be allowed on the premises unless accompanied by an adult.

20. Unless attending a private function at the premises and accompanied by an adult, under 18's shall not be allowed in the premises after 8pm when regulated entertainment is offered.

21. Any persons apparently under the age of 18 years shall be asked for photographic proof of age, i.e. passport or photo driving licence.

22. Staff shall be instructed that persons who look under 18 years must be asked for identification before they will be sold alcohol or admitted to the premises on certain occasions.

23. There shall be no new entries to the first floor of the premise after 01:00.

24. Substantial food and non-intoxicating beverages, including drinking water, shall be available in all parts of the premises where alcohol is sold or supplied for consumption on the premises.

25. On Thursday, Friday and Saturday after 10pm a minimum of 2 SIA licensed door supervisors shall be on duty at the premises whilst it is open for business unless a waiver is granted in advance by the Metropolitan Police Service.

26. The following policies/ documents will be provided to the Police and Council Licensing Officers on request: (1) Security Policy (2) Management Structure (3) Dispersal Policy (4) Staff Training.

27. CCTV covering areas inside and outside of the premises should be installed and maintained to Police recommendations with properly maintained log arrangements. All images shall be stored for a minimum of 31 days.

28. CCTV is to comply with Data Protection Act and is to be working and recording correctly when the premises are open to the public. If the CCTV is not working then the premise shall comply with requests by Police, including suspension of licensable activity.

29. A staff member from the premises that is conversant with the operation of the CCTV system shall be on the premises at all times that the premises are open to the public. This staff member shall be able to show police recent data footage with the minimum of delay when requested. This data footage reproduction should be almost instantaneous.

Annex 3 – Conditions attached after a hearing by the licensing authority

30. The licensee shall ensure that no live music or amplified sound associated with a licensable activity, which emanates from the licensed premises, is audible at or within the site boundary of any residential property.

31. The licensee shall ensure that no structure-borne vibration caused in connection with a licensable activity shall be perceptible at or within the site boundary of any residential property.

32. The licensee shall maintain a permanent written record of complaints received about the operation of the premises, containing the complainants name and location, the date and time the complaint is received, details of the complaint, and subsequent remedial action undertaken.

The complaints record shall be kept for at least 18 (eighteen) months after the date of the complaint and shall be available at all reasonable times for inspection by council officers.

33. The Licensee shall arrange a meeting at least three times a year to which local residents shall be invited. The purpose of each such meeting shall be to discuss matters of mutual concern. The licensee shall use all reasonable endeavours to publicise these meetings, minutes of which shall be circulated to all those attending and to the Council and shall be made available at the premises.

34. The outside drinking areas of the premises shall not be used after 22.00.

35. On match days/victory parades at Chelsea FC there will be no alcohol consumed outside the front of the premises for a period of 2 hours before the advertised kick off time and until 1 hour after the match/event.

36. The total number of persons on the premises at any one time shall not exceed five hundred and fifty (550) (excluding staff), 400 on the ground floor and 150 on the 1st floor.

37. The licensee shall employ a suitable number of SIA registered staff at the premises in accordance with the Metropolitan Police.

38. On Home Football matches at Chelsea Football Club there should be 3 door supervisors on the premises from 3 hours before the game and until 3 hours after the game.

39. On days that the premises opens for sporting events before usual licensing hours there should be 3 door supervisors on the premises from 1 hours before the event and until 1 hours after the event.

40. The licensee shall use all reasonable endeavours to manage any queuing for admission to the premises to ensure that there is no nuisance or disturbance to neighbours and obstruction of the public footway.

41. The licensee shall use all reasonable endeavours to ensure that no customers leave the premises carrying any glass, bottle or drink other than when the Tables and Chairs Licence is in use, and in any event, not after 9pm.

42. The premises shall install and maintain a comprehensive CCTV system as per the minimum requirements of a Metropolitan Police Crime Prevention officer. All entry and exit points will be covered enabling frontal identification of every person entering in any light condition. The CCTV system shall continually record whilst the premises is open for licensable activities and during all times when customers remain on the premises. All recordings shall be stored for a minimum period of 31 days. Recordings shall be made available immediately upon the request of the Metropolitan

Police or authorised officer of the London Borough of Hammersmith and Fulham throughout the preceding 31 day period.

43. Notices will be prominently displayed at the exits requesting customers to respect the needs of local residents and to leave the premises and the area quietly.

44. A telephone number shall be displayed, so that it is plainly visible from the public highway, for members of the public to lodge complaints whilst regulated entertainment is taking place.

45. Windows shall be kept shut from 8pm hours when regulated entertainment is taking place.

46. Alcohol shall not be consumed other than during the hours permitted by the licence for the sale of alcohol, and during a 30-minute period immediately following the permitted hours.

47. The means of escape provided for all persons on the premises shall be maintained unobstructed and immediately available. Where tables and seats are provided clear gangways to exits shall be maintained to the ways etc, satisfaction of the Licensing Authority. Except with the consent of the Licensing Authority, bars, wire guards or the like shall not be fitted to windows, nor shall the windows be otherwise obstructed in a manner likely to render them unavailable for the purpose of rescue in case of emergency. This must not be interpreted as giving permission for means of escape from licensed premises to be obstructed at times when the premises are not being used under the licence. The means of escape, including the availability of all exit passageways and doors, approved in connection with the grant of an entertainment licence should be maintained at all times during which the premises are occupied.

48. While the public are on the premises exit doors and gates shall not be secured closed by means of any fastenings other than panic bolts. Locking bars, hasps, staples, screw eyes or other fastenings not approved by the Council shall not be fitted on exit doors.

49. Any removable fastenings permitted by the Council for securing exit doors when the public are not on the premises shall be removed before the public are admitted to the premises and shall not be replaced while the public are on the premises. This must not be interpreted as giving permission for means of escape from licensed premises to be obstructed at times when the premises are not being used under the licence. The means of escape, including the availability of all exit passageways and doors, approved in connection with the grant of an entertainment licence should be maintained at all times during which the premises are occupied.

50. All fire-resisting doors and smoke-stop doors shall be maintained self-closing and shall not be kept secured open.

51. Fire appliances and equipment as approved by the Licensing Authority shall be efficiently maintained in satisfactory working order and kept available for instant use.

52. Portable fire appliances shall be examined at least once a year and periodically tested in accordance with the current British Standard by a competent person and the

date of such tests shall be clearly marked on the appropriate extinguishers or on stout tabs securely attached to them. Extinguishers which incorporate an antifreeze agent shall be examined and recharged in compliance with manufacturer's instructions.

53. No balloons filled with flammable gas shall be on the premises.

54. Portable cooking or heating appliances shall not be used except with the consent of the Council in writing.

55. Appliances utilising cylinders or containers of gas under pressure shall not be used on the premises except in accordance with such conditions as the Council may deem necessary.

56. Any gas-meter or electricity-meter enclosure provided shall be used and exclusively for the accommodation of the meter and its connections and the electrical area around the equipment, whether enclosed or not, shall be kept clear and unobstructed.

57. The general lighting shall be maintained alight and the lighting to 'SAFETY SIGNS' notices shall not in any circumstances be extinguished or dimmed while the public are on the premises, provided that so long as there is sufficient daylight in any part of the premises, artificial light need not be used in that part.

58. A satisfactory certificate (or properly certified duplicate) shall be Certificates submitted to the Council in respect of any boiler, calorifier or air heater situated on or in the immediate vicinity of the licensed part of the premises. In the case of an oil-fired or gas-fired boiler or air heater, the certificate shall be accompanied by a statement that the condition of the oil-fuel or gas equipment including the burners and safety devices is satisfactory. All certificates submitted are retained by the Licensing Authority.

59. NOTE - Unless otherwise agreed by the Licensing Authority certificates are required for any boiler or calorifier (other than a boiler or calorifier in which both the primary and secondary systems are open to atmosphere at all times) after thorough examination and test by a boiler insurance company before first use and after the grant of a licence; and thereafter at such times as the Council may require in writing. For small low-pressure hot-water domestic boilers other sectional boilers a certificate may be accepted after examination by the manufacturers or their appointed agents and, if the examiners state on the certificate the period (not exceeding three years) for which the boiler is regarded as serviceable, it will be accepted for such a period. The Licensing Authority may also require certificates to be submitted in respect of hotplates or other apparatus working under pressure.

60. Unless the Council shall decide otherwise an inspection certificate in the form prescribed in the current edition of the Regulations for the Electrical Equipment of Buildings issued by the Institution of Electrical Engineers shall be submitted to the Council once in every five years or at such other times as is specified on the current certificate. The certificate shall state that the installation is in a safe working condition and shall be signed by a suitably qualified electrical engineer or other person deemed competent. All certificates submitted are retained by the Council.

61. If the approved system of safety lighting incorporates a storage battery:

- a) The battery shall be fully charged before admission of the public on any day.
- b) The battery shall be under the regular maintenance of a firm of accumulator manufacturers or, with the prior approval of the Council, other persons deemed competent who shall arrange for a thorough examination at least once in every six months, when, in the case of a floating battery, the battery shall be tested by taking its full load for its rated discharge period or for three hours (whichever is the less). A trickle-charged battery shall be subjected to a similar test at such times as the Council may require. In addition, any automatic devices provided shall be tested frequently to ensure their correct operation.
- c) At least once in every six months a properly certified report as to the condition of the battery, including details of the examination and, where appropriate, the battery tests, shall be submitted to the Council. Where self-contained battery operated safety lighting units are installed, the certificate shall state that each unit has been energised from its battery for 'the requisite period'.

62. All certificates submitted are retained by the Council.

63. In the event of failure of the general system of lighting, the public shall be required to leave the building within a maximum of one hour, or thirty minutes in the case of a building in which a storage battery having a rated discharge period of one hour is provided, and shall not be readmitted until the lighting from that system has been fully restored and the battery fully recharged.

64. On the ground floor there shall be no new entries to the premises after 00:00.

Signed: 
Authorised Officer

Date: 04.01.2024

Annex 4- Plans:

Please insert plans at page 12

Licensing Act 2003

Premises Licence



Premises Licence Summary

Premises Licence Number: 2023/02069/LAPR

Premises details

Postal address of premises, or if none, OS map reference or description of the premises

Ground & First Floor
Broadway Bar & Grill
474 - 476 Fulham Road

Post town: London

Post code: SW6 1BY

Telephone:

Where the licence is time limited the dates:

Not Applicable

Licensable activities authorised by the licence:

Exhibition of a Film -Indoors Only
Performance of Live Music -Indoors Only
Playing of Recorded Music -Indoors Only
Entertainment Similar to Music or Dance -Indoors Only
Provision of Late Night Refreshment -Indoors Only
Sale of Alcohol On and Off the Premises

The licence authorises the carrying out of the following licensable activities on the days and at the times specified below:

Exhibition of a Film -Indoors Only
Monday to Sunday 10:00 - 01:00

Performance of Live Music -Indoors Only
Monday to Sunday 10:00 - 01:00

Playing of Recorded Music -Indoors Only
Monday to Sunday 10:00 - 01:00

Entertainment Similar to Music or Dance -Indoors Only
Monday to Sunday 10:00 - 01:00

Provision of Late Night Refreshment -Indoors Only

Monday to Sunday 23:00 - 02:00 (First Floor)

Monday to Sunday 23:00 - 01:00 (Ground Floor)

Sale of Alcohol On and Off the Premises

Monday to Sunday 10:00 - 01:00 (Ground Floor)

Monday to Sunday 10:00 - 02:00 (First Floor)

Non Standard Timings and Seasonal Variations: On Saturdays when Chelsea Football Club play at home the start time will be 11:00

The opening hours of the premises:

Monday to Sunday 10:00 - 02:30

Where the licence authorises supplies of alcohol whether these are on and / or off supplies:

On and off the premises

Name, (registered) address, of holder of premises licence:

Eduardo Dantas
126 South Lambeth Road
London
SW8 1RB

Registered number of holder, for example company number, charity number (where applicable):

Not applicable

Name of designated premises supervisor where the premises licence authorises the supply of alcohol:

Eduardo Dantas

State whether access to the premises by children is restricted or prohibited:

See Annex 2

Signed: 
Authorised Officer

Date: 04.01.2024

- 1. 1/2" = 1'-0" Scale
- 2. 1/4" = 1'-0" Scale
- 3. 1/8" = 1'-0" Scale
- 4. 1/16" = 1'-0" Scale
- 5. 1/32" = 1'-0" Scale
- 6. 1/64" = 1'-0" Scale
- 7. 1/128" = 1'-0" Scale
- 8. 1/256" = 1'-0" Scale
- 9. 1/512" = 1'-0" Scale
- 10. 1/1024" = 1'-0" Scale

SLUG AND LETTUCE, SWS

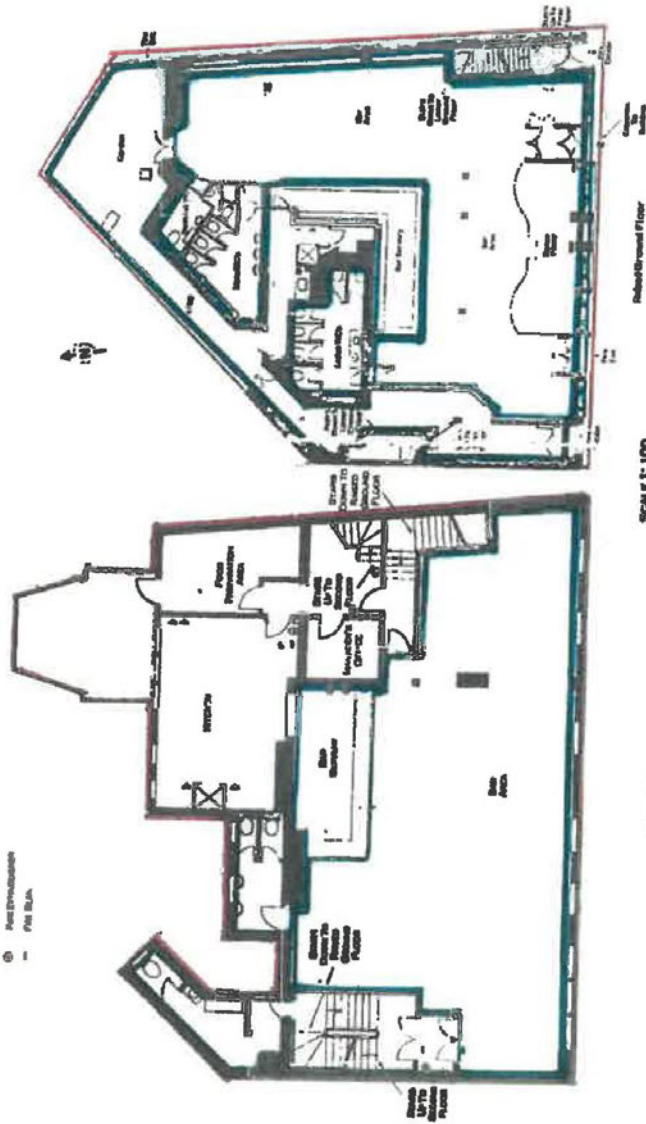

SCALE: 1/8" = 1'-0"
 © 2015 BY SWS
 No. 100 1700 SWS

License number:
 2015054781 APRTV